

MOTOPLASTIC, S.A.

Molí de la sal, 1 - 08403 Granollers (Barcelona) SPAIN

Tel. 34 93 849 06 33 - Fax 34 93 849 09 88

info@puig.tv - info@puigusa.com

www.puig.tv - www.puigusa.com

Ref.: 7646

INSTRUCCIONES DE MONTAJE - MOUNTING INSTRUCTIONS - MONTAGEANLEITUNG

CÚPULA TOURING PARA - TOURING SCREEN FOR - WINDSCHUTZSCHEIBE FÜR YAMAHA MT09 TRACER



ID.	PIEZA / PART	DESCRIPCIÓN	DESCRIPTION	QTY.
1		Cúpula touring	Touring screen	1
2		Soporte metálico	Metal support	1
3		Desplazador manoplas con tuerca M5	Handguard displacer with M5 thread	4
4		Tornillo Allen M6x10 ISO 7380	M6x10 ISO 7380 Allen screw	4
5		Silentblock M5	M5 silentblock	4
6		Tornillo Allen M5x10 ISO 7380 (color plata)	M5x10 ISO 7380 Allen screw (silver color)	4
7		Tornillo Allen M5x16 ISO 7380 (color negro)	M5x16 ISO 7380 Allen screw (black color)	8
8		Arandela de nylon M5x0,5	M5x0,5 nylon washer	4
9		Separador de silicona Ø12x4mm	Ø12x4mm silicon separator	2
10		Tapon tornillo M5	M5 screw cap	4

MOTOPLASTIC, S.A.

Molí de la sal, 1 - 08403 Granollers (Barcelona) SPAIN

Tel. 34 93 849 06 33 - Fax 34 93 849 09 88

info@puig.tv - info@puigusa.com

www.puig.tv - www.puigusa.com

INSTRUCCIONES DE MONTAJE - MOUNTING INSTRUCTIONS - MONTAGEANLEITUNG

CÚPULA TOURING PARA - TOURING SCREEN FOR - WINDSCHUTZSCHEIBE FÜR YAMAHA MT09 TRACER

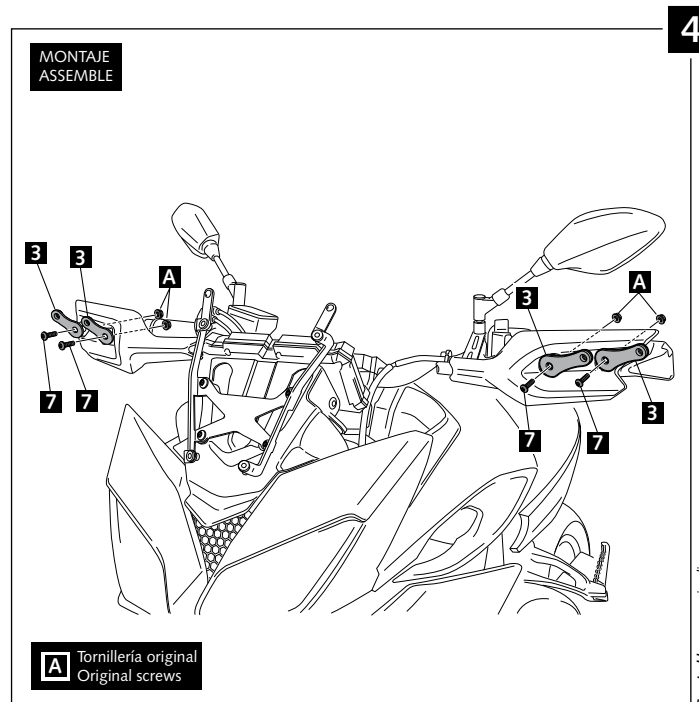
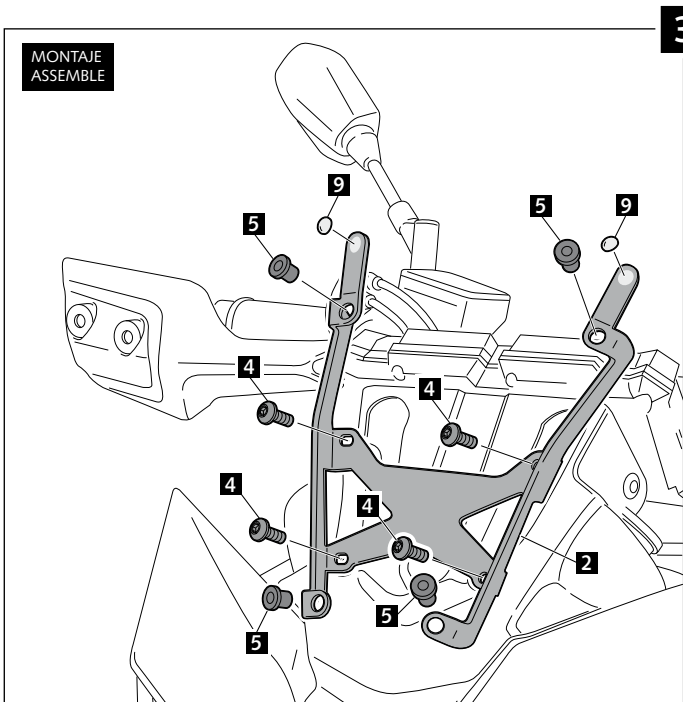
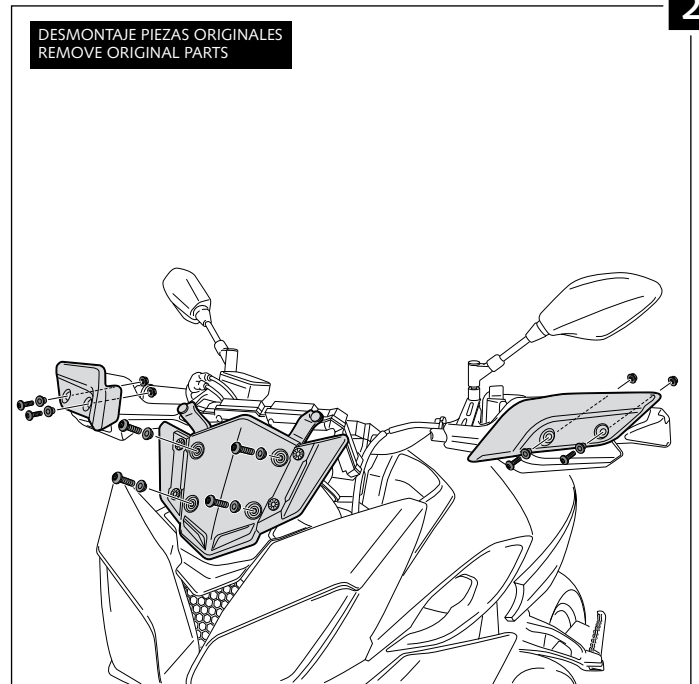
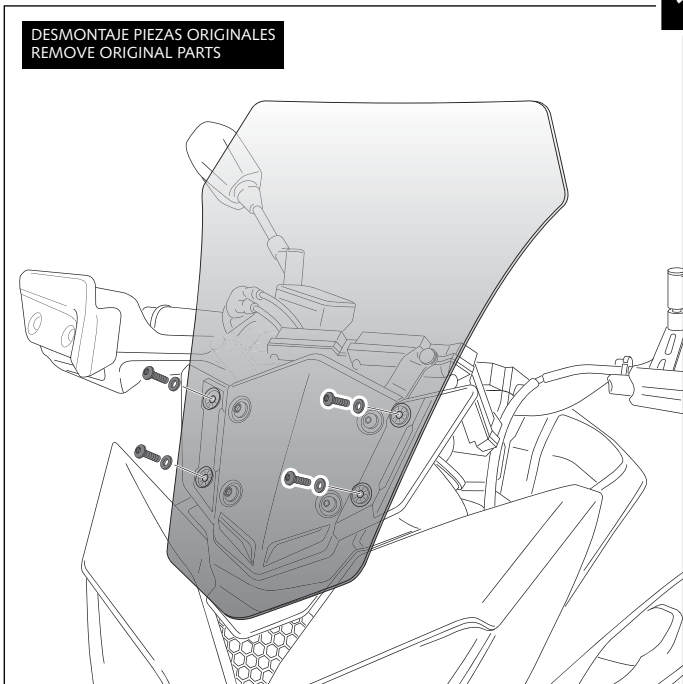

MOTOPLASTIC, S.A.

Molí de la sal, 1 - 08403 Granollers (Barcelona) SPAIN

Tel. 34 93 849 06 33 - Fax 34 93 849 09 88

info@puig.tv - info@puigusa.com

www.puig.tv - www.puigusa.com

INSTRUCCIONES DE MONTAJE - MOUNTING INSTRUCTIONS - MONTAGEANLEITUNG

CÚPULA TOURING PARA - TOURING SCREEN FOR - WINDSCHUTZSCHEIBE FÜR YAMAHA MT09 TRACER

5

MONTAJE
ASSEMBLE

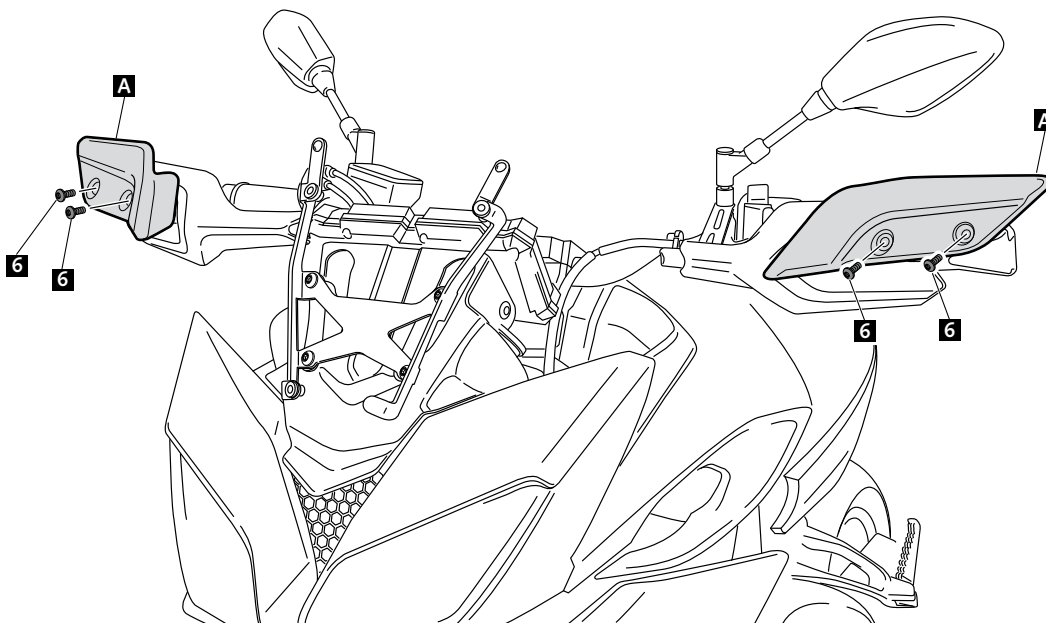

A Pieza original
Original part

6

MONTAJE
ASSEMBLE

